



**PRO  
LUX**



## **LED 740 BY**

Please keep reading this manual carefully for further use!

**USER MANUAL**

# 1. UNPACKING

Thank you for choosing our fixture. For your own safety, please read this manual before installing the device. This manual covers the important information on installation and applications. Please install and operate the fixture with following instructions.

Meanwhile, please keep this manual well for future needs.

This fixture is made of a new type of high temperature strength of engineering plastics and cast aluminum casing with nice outlook. The fixture is designed and manufactured strictly following CE standards, complying with international standard DMX512 protocol. It's available independently controlled and linkable with each other for operation. And it is applicable for large-scale live performances, theater, studio, nightclubs and discos.

4-IN-1 LEDs(RGBW) which features high brightness and stability. Please carefully unpack it when you receive the fixture and check whether it is damaged during the transportation. And please check whether the following items are included inside the box:

- LED Moving head ..... 1
- Power Cable..... 1
- 3-Pin Signal Cable ..... 1
- Safety Cable ..... 1
- Omega Branket ..... 2
- User Manual ..... 1

## 2. FIXTURE SIZE

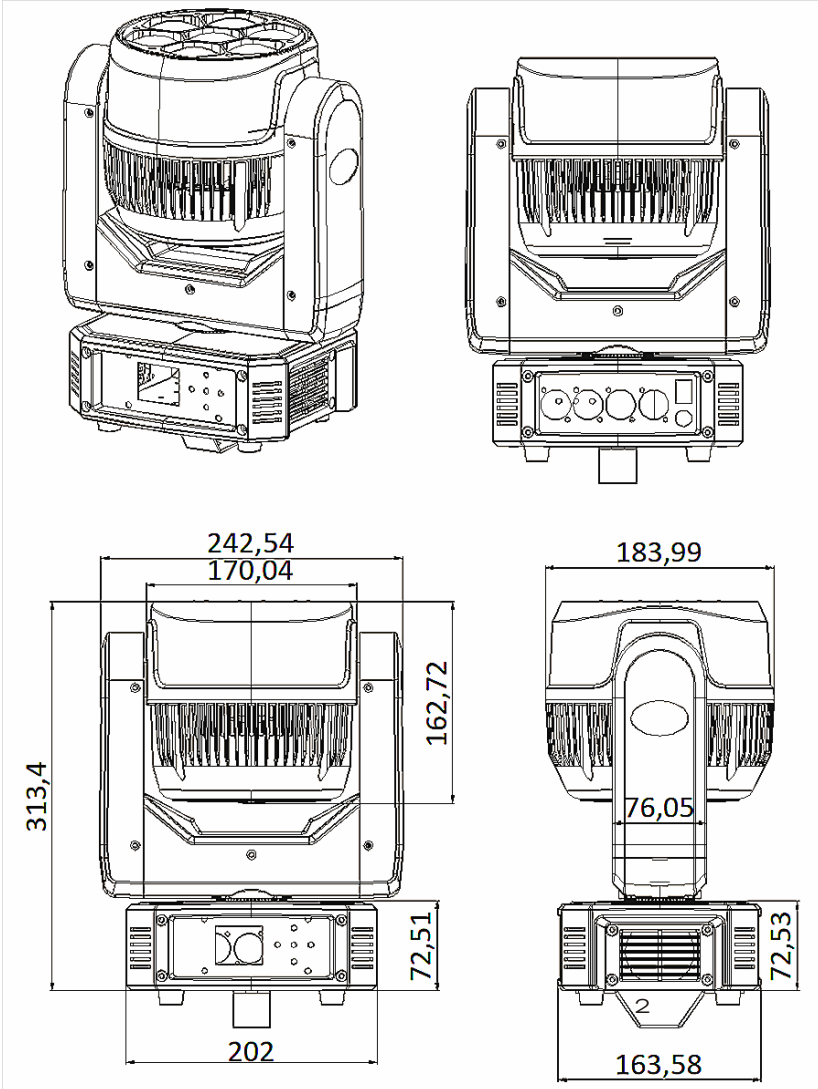

### 3. SAFETY INSTRUCTIONS



**CAUTION!**

Be careful with your operations. With a dangerous voltage you can suffer a dangerous electric shock when touching wires!

This device has left the factory in perfect condition. In order to maintain this condition and to ensure a safe operation, it is absolutely necessary for the user to follow the safety instructions and warning notes written in this user manual.



**Important:**

*Damages caused by the disregard of this user manual are not subject to warranty. The dealer will not accept liability for any resulting defects or problems.*

If the device has been exposed to temperature changes due to environmental changes, do not switch it on immediately. The arising condensation could damage the device. Leave the device switched off until it has reached room temperature.

This device falls under protection-class I. Therefore it is essential that the device be earthed.

The electric connection must carry out by qualified person. The device shall only be used with rate voltage and frequency.

Make sure that the available voltage is not higher than stated at the end of this manual.

Make sure the power cord is never crimped or damaged by sharp edges. If this would be the case, replacement of the cable must be done by an authorized dealer.

Always disconnect from the mains, when the device is not in use or before cleaning it. Only handle the power cord by the plug. Never pull out the plug by tugging the power cord.

During initial start-up some smoke or smell may arise. This is a normal process and does not necessarily mean that the device is defective, it should decrease gradually.

Please don't project the beam onto combustible substances.

Fixtures cannot be installed on combustible

substances, keep more than 50cm distance with wall for smooth air flow, so there should be no shelter for fans and ventilation for heat radiation.

If the external flexible cable or cord of this luminaire is damaged, it shall be exclusively replaced by the manufacturer or his service agent or a similar qualified person in order to avoid a hazard.

Don't use the fixture in RGBW full on for more than 10 minutes incase of high temperature damage the fixtures.

## **4. OPERATION INSTRUCTIONS**

- The fixture is for wash effect for on-site decoration purpose.
- Don't turn on the fixture if it's been through severe temperature difference like after transportation because it might damage the light due to the environment changes. So make sure to operate the fixture until it is in normal temperature.
- This light should be keep away from strong shaking during any transportation or movement.
- Don't pull up the light by only the head, or it might cause damages to the mechanical parts.
- Don't expose the fixture in overheat, moisture or environment with too much dust when installing it. And don't lay any power cables on the floor. Or it might cause electronic shock to the people.
- Make sure the installation place is in good safety condition before installing the fixture.
- Make sure to put the safety chain and check whether the screws are screwed properly when installing the fixture.
- Make sure the lens are in good condition. It's recommended to replace the units if there are any damages or severe scratch.
- Make sure the fixture is operated by qualified

personnel who knows the fixture before using.

- Keep the original packages if any second shipment is needed.
- Don't try to change the fixtures without any instruction by the manufacturer or the appointed repairing agencies.
- It is not in warranty range if there are any malfunctions from not following the user manual to operate or any illegal operation, like shock short circuit, electronic shock, lamp broke, etc.

## 5. MOUNTING AND INSTALLATION

**Cautions:** For added protection mount the fixtures in areas outside walking paths, seating areas, or in areas where the fixture might be reached by unauthorized personnel.

Before mounting the fixture to any surface, make sure that the installation area can hold a minimum point load of 10 times the device's weight. Fixture installation must always be secured with a secondary safety attachment, such as an appropriate safety cable.

Never stand directly below the device when mounting, removing, or servicing the fixture from a periodic safety inspection of all installation material and the fixture. If you lack these qualifications, do not attempt the installation yourself. Improper installation can result in bodily injury.

Be sure to complete all rigging and installation procedures before connecting the main power cord to the appropriate wall outlet.

**Clamp Mounting:** The Mini 740 B-eye provides a

unique mounting bracket assembly that integrates the bottom of the base, and the safety cable rigging point in one unit (see the illustration below). When mounting this fixture to truss be sure to secure an appropriately rated clamp to the included omega bracket using a M10 screw fitted through the center hole of the “omega bracket”. As an added safety measure be sure to attach at least one properly rated safety cable to the fixture using on of the safety cable rigging point integrated in the base assembly

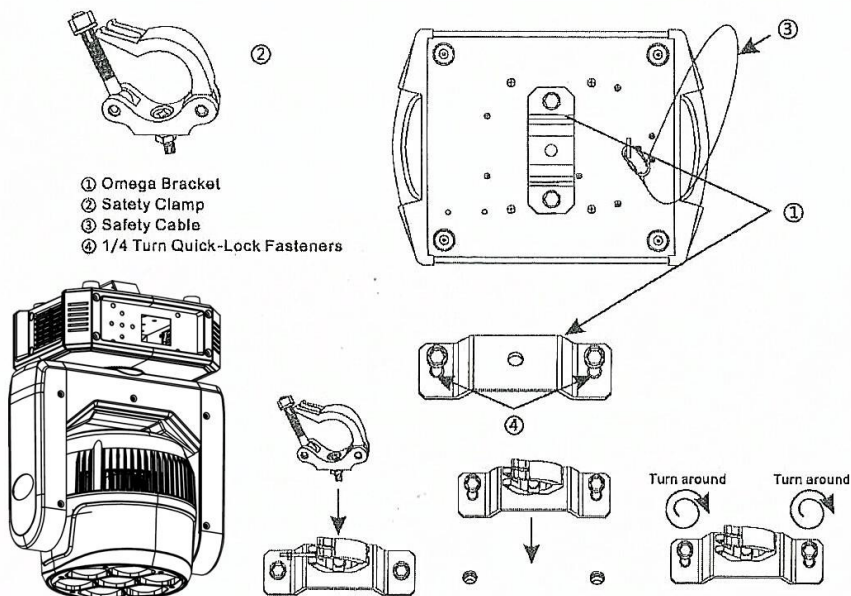

Regardless of the rigging option you choose for your Mini 740 B-eye, always be sure to secure your fixture with a safety cable. The fixture provides a built-in rigging point for a safety cable on the hanging bracket as illustrated above. Be sure to only use the designated rigging point for the safety cable and never secure a safety cable to a carrying handle.

## 6. DMX-512 CONTROL CONNECTIONS

Connect the provided XLR cable to the female 3-pin XLR output of your controller and the other side to the male 3-pin XLR input of the moving head. (5-pin connect way is similar)

You can chain multiple Moving heads be connected together through serial linking. The cable needed should be two core, screened cable with XLR input and output connectors. Please refer to the diagram below.

### DMX-512 CONNECTION WITH DMX TERMINATOR

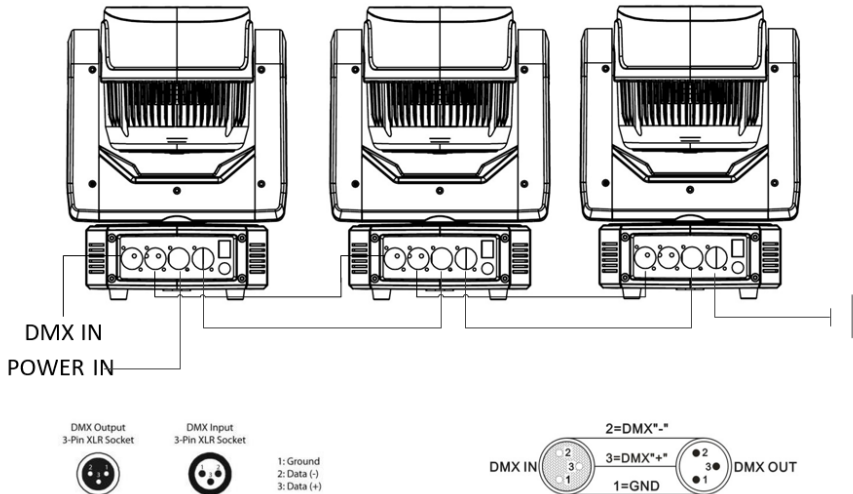

For installations where the DMX cable has to run a long distance or is in an electrically noisy environment, such as in a discotheque, it is recommended to use a DMX terminator. This helps in preventing corruption of the digital control signal by electrical noise. The DMX terminator is simply an

XLR plug with a 120 Ω resistor connected between pins 2 and 3, which is then plugged into the output XLR socket of the last fixture in the chain. Please see illustrations below.

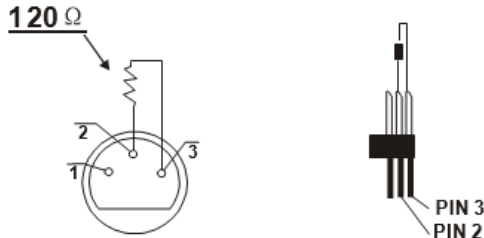

## 7. DMX CHANNELS

### 23CH

CH	Function	DMX	Details
1	Pan	0-255	Pan movement control
2	Pan fine	0-255	Pan fine control
3	Tilt	0-255	Tilt movement control
4	Tilt fine	0-255	Pan fine control
5	Pan/Tilt	0-255	Speed from fast to slow
6	ZOOM	0-255	Zoom
7	LENS rotation	0-127	0 to 60 degree
		128-188	Unlimited anticlockwise rotation from fast to slow
		189-193	Stop
		194-255	Unlimited clockwise rotation from fast to slow
8	Dimmer	0-255	0-100 linear dimmer from dark to bright

9	Strobe	0-3	Open
		4-103	Strobe with the same step from slow to fast
		104-107	No function(Light on)
		108	Light off
		109-207	Pulse strobe from slow to fast
		208-212	No function(Light on)
		213-251	Random strobe from slow to fast
		252-255	No function(Light on)
10	R	0-255	1-100% Red linear dimmer from dark to bright
11	G	0-255	1-100% Green linear dimmer from dark to bright
12	B	0-255	1-100% Blue linear dimmer from dark to bright
13	W	0-255	1-100% White linear dimmer from dark to bright
14	Color	0-255	Linear color temperature control
15	Macro	0-255	Macro color change
16	Static effect (15 kinds)	0-29	No function
		30-255	Each 5 DMX value is a kind of static effect
17	Dynamic effect	0-14	No function
		15-204	38 kinds of dynamic effects
		205-255	39 kinds dynamic effect
18	Dynamic effect speed	0-63	No function
		64-158	Clockwise Speed from fast to slow
		159-160	Stop
		161-255	Anticlockwise speed from slow to fast
19	Background	0-255	0-100% Background Red linear dimmer from dark
20	Background	0-255	0-100% Background Green linear dimmer from dark

21	Background	0-255	0-100% Background Blue linear dimmer from dark
22	Background	0-255	0-100% Background White linear dimmer from dark
23	Reset	0-26	No function
		27-76	Lens rotation and zoom reset
		77-127	Pan/Tilt reset
		128-255	All function reset

### 35 CH

CH	Function	DMX	Details
1	Red	0-255	Red dimmer
2	Red Fine	0-255	Red fine control
3	Green	0-255	Green dimmer
4	Green Fine	0-255	Green fine control
5	Blue	0-255	Blue dimmer
6	Blue Fine	0-255	Blue fine control
7	White	0-255	White dimmer
8	White Fine	0-255	White fine control
9	CTO	0-255	Color temperature linear control
10	Macro colour	0-255	Macro color control
11	strobe	0-4	Open
		5-103	Strobe with the same step from slow to fast
		104-107	No function(Light on)
		108	Light off
		109-207	Pulse strobe from slow to fast
		208-212	No function(Light on)
		213-251	Random strobe from slow to fast
		252-255	No function(Light on)
12	Dimmer	0-255	0-100 linear dimmer from dark to bright
13	Dimmer Fine	0-255	Dimmer fine control

14	Pan	0-255	Pan movement control
15	Pan Fine	0-255	Pan fine control
16	Tilt	0-255	Tilt movement control
17	Tilt Fine	0-255	Pan fine control
18	Reversed	0-255	Reversed channel
19	Reset	0-26	No function
		27-76	Lens rotation and zoom reset
		77-127	Pan/Tilt reset
		128-255	All function reset
20	Zoom	0-255	Zoom
21	Zoom Rotation	0-127	0 to 60 degree
		128-188	Unlimited anticlockwise rotation from fast to
		189-193	Stop
		194-255	Unlimited clockwise rotation from fast to slow
22	Shape Selection	0-255	Selecting shape(9-70 variable)
23	Shape Speed	0-255	Shape speed from slow to fast
24	Shape Fade	0-255	Shape fade
25	Shape R	0-255	Shape in Red color
26	Shape G	0-255	Shape in Green color
27	Shape B	0-255	Shape in Blue color
28	Shape W	0-255	Shape in White color
29	Shape Dimmer	0-255	Shape dimmer 0-100%
30	Background	0-255	Background dimmer 0-100%
31	Shape Transition	0-255	Shape change
32	Shape Offset	0-255	Shape offset
33	Foreground strobe	0-255	Foreground strobe control
34	Background strobe	0-255	Background strobe control
35	Background	0-255	Background selection

## 51 CH

CH	Function	DMX	Details
1	Pan	0-255	Pan movement control
2	Pan fine	0-255	Pan fine control
3	Tilt	0-255	Tilt movement control
4	Tilt fine	0-255	Pan fine control
5	Pan/Tilt	0-255	Speed from fast to slow
6	ZOOM	0-255	Zoom
7	LENS rotation	0-127	0 to 60 degree
		128-188	Unlimited anticlockwise rotation from fast to slow
		189-193	Stop
		194-255	Unlimited clockwise rotation from fast to slow
8	Dimmer	0-255	0-100 linear dimmer from dark to bright
9	Strobe	0-3	Open
		4-103	Strobe with the same step from slow to fast
		104-107	No function(Light on)
		108	Light off
		109-207	Pulse strobe from slow to fast
		208-212	No function(Light on)
		213-251	Random strobe from slow to fast
		252-255	No function(Light on)
10	R	0-255	1-100% Red linear dimmer from dark to bright
11	G	0-255	1-100% Green linear dimmer from dark to bright
12	B	0-255	1-100% Blue linear dimmer from dark to bright
13	W	0-255	1-100% White linear dimmer from dark to bright
14	Color	0-255	Linear color temperature control
15	Macro	0-255	Macro color change

16	Static effect (15 kinds)	0-29	No function
		30-255	Each 5 DMX value is a kind of static effect
17	Dynamic effect	0-14	No function
		15-204	38 kinds of dynamic effects
		205-255	39 kinds dynamic effect
18	Dynamic effect speed	0-63	No function
		64-158	Clockwise Speed from fast to slow
		159-160	Stop
		161-255	Anticlockwise speed from slow to fast
19	Background	0-255	0-100% Background Red linear dimmer from dark
20	Background	0-255	0-100% Background Green linear dimmer from dark
21	Background	0-255	0-100% Background Blue linear dimmer from dark
22	Background	0-255	0-100% Background White linear dimmer from dark
23	Reset	0-26	No function
		27-76	Lens rotation and zoom reset
		77-127	Pan/Tilt reset
		128-255	All function reset
24	Red 1	0-255	LED 1 red dimmer
25	Green 1	0-255	LED 1 green dimmer
26	Blue 1	0-255	LED 1 blue dimmer
27	White 1	0-255	LED 1 white dimmer
---	-----	-----	-----
---	-----	-----	-----
48	Red 7	0-255	LED 7 red dimmer
49	Green 7	0-255	LED 7 green dimmer
50	Blue 7	0-255	LED 7 blue dimmer
51	White 7	0-255	LED 7 white dimmer

## 8. DISPLAY INSTRUCTION

Address	001-512	
System Setup	Run Mode	DMX
		Sound
		Auto 1
		Auto 2
	Channel	23 CH
		35 CH
		51 CH
	Invert Pan	ON
		OFF
	Invert Tilt	ON
		OFF
	Hall Crct	ON
		OFF
	Encoder Crct	ON
		OFF
	Signal keep	ON
		OFF
	Invert Screen	Auto
		ON
		OFF
	Update Slave	ON
		OFF
	Language	EN
		CH
	Dimmer Curve	Curve1
		Curve2
		Curve3
		Curve4
	Speed Mode	Normal
		Fast

	Load Default	
Manual	Manual control each channel	
Motor Calibration	PAN	Don't change the data unless it's necessary
	TILT	
	Focus	
	Rotate	
	Balance-Red1	
	Balance-Green1	
	Balance-Blue1	
	Balance-White1	
	.....	
	.....	
	Power	
	MIC	
	Change password	
Note	System information	
Reset	Reset effect	
	Reset Scan	
	Reset All	

## 9. PHOTOMETRIC DATA:

LUX Data of 5 degree beam angle:

R	5050 lux@3m	1880 lux@5m	670 lux@8m
G	9300 lux@3m	3480 lux@5m	1285lux@8m
B	12650 lux@3m	6600 lux@5m	2420 lux@8m
W	17050 lux@3m	6400 lux@5m	2380 lux@8m
RGBW	42300 lux@3m	16140 lux@5m	5760 lux@8m

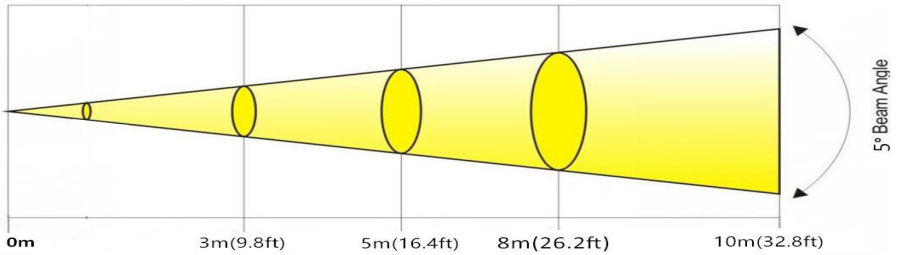

LUX Data of 45 degree beam angle:

R	330 lux@3m	115 lux@5m	48 lux@8m
G	610 lux@3m	235 lux@5m	90 lux@8m
B	1160 lux@3m	450 lux@5m	172 lux@8m
W	1150 lux@3m	435 lux@5m	166 lux@8m
RGBW	2900 lux@3m	1050 lux@5m	420 lux@8m

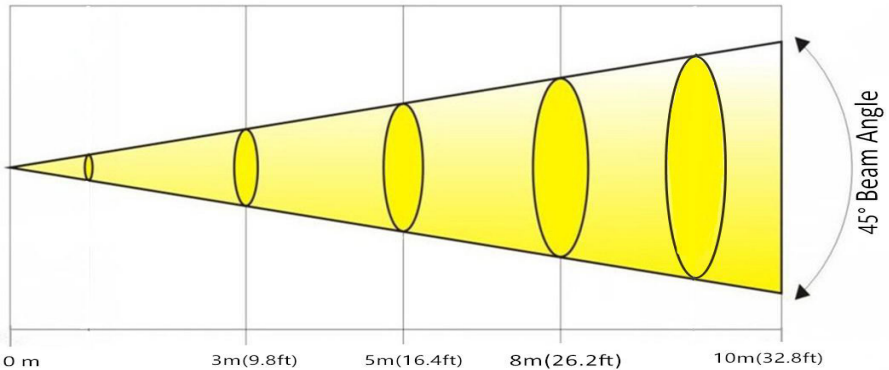

## 10. KEY FEATURES

- Voltage: AC90-240V 50-60HZ
- Max Power: 300W
- Source: 7pcs 40w high brightness RGBW 4-in-1 LEDs

- LED working lifetime: Average 50,000 hours with low power consumption
- Dimmer: 0-100% linear dimming system
- Strobe: 1-25 times/second Pan:540°+ fine
- Tilt:270° +fine
- Zoom: 5-45°
- Channel: 23/35/51 three DMX channel mode
- Control: DMX512/master-slave/auto/sound
- Color: RGBW infinite mixture
- Display: LCD display
- Fixture size: 250\*250\*370 mm
- N.W: 5.5KG
- Each led is controllable individually. Built-in with macro effects.
- Frost lens can rotate without limitation to create dynamic effect Fast Pan/tilt speed
- Mini housing to make installation easier

## **11. MAINTENANCE AND CLEANING**

The following points have to be considered during the inspection:

1. All screws for installing the devices or parts of the device have to be tightly connected and must not be corroded.
2. There must not be any deformations on the housing, color lenses, fixations and installation spots (ceiling, suspension, trussing).
3. Mechanically moved parts must not show any traces of wearing and must not rotate with unbalances.
4. The electric power supply cables must not show any damage, material fatigue or sediments.

Further instructions depending on the installation spot and usage have to be adhered by a skilled installer and any safety problems have to be removed.



**CAUTION!**

Disconnect from mains before starting maintenance operation.

In order to make the lights in good condition and extend the life time, we suggest a regular cleaning to the lights.

1. Clean the inside and outside lens each week to avoid the weakness of the lights due to accumulation of dust.
2. Clean the fan each week.
3. A detailed electric check by approved electrical engineer each three month, make sure that the circuit contacts are in good condition, prevent the poor contact of circuit from overheating.

We recommend a frequent cleaning of the device. Please use a moist, lint- free cloth. Never use alcohol or solvents. There are no serviceable parts inside the device. Please refer to the instructions under “Installation instructions”. Should you need any spare parts, please order genuine parts from your local dealer

